

FILED FOR RECORD: 12-2 19 83 at 9:00 o'clock A M
 DULY RECORDED: 12-6 19 83 at 9:00 o'clock A M
 INSTRUMENT NO. _____ GRACE BOSTICK TYLER CO. CLK.
 BY: Jean Phillips Deputy
 JEAN PHILLIPS

TYLER COUNTY COMMISSIONER'S COURT
 SPECIAL MEETING
 NOVEMBER 18, 1983---10:00 A. M.

VOL 008 PAGE 732

A Special Meeting of the Commissioner's Court met on Friday, November 18, 1983 at 10:00 A. M. All members being present except Commissioner Berton A. Odom. The meeting was opened with prayer by Judge Allen Sturrock.

A motion was made by Commissioner Mahan and seconded by Commissioner Riley to table until a later date any decision to be made concerning the appointing of members to the Child Welfare Board. All voted yes and none no.

A motion was made by Commissioner Riley and seconded by Commissioner Lowe to approve the appointment of members to the Tyler County Sesquicentennial Committee. All voted yes and none no. See Attached.

A motion was made by Commissioner Mahan and seconded by Commissioner Riley to approve the purchase of 3/4 acres of land in Precinct #3 located on Highway 69, North of Colmesneil, Texas. All voted yes and none no. See Attached.

A motion was made by Commissioner Mahan and seconded by Commissioner Lowe to approve giving the amount of \$150.00 each to cover the cost of Christmas gifts to the foster children now under Tyler County's supervision. All voted yes and none no.

A motion was made by Commissioner Mahan and seconded by Commissioner Lowe to approve the bid received from Lufkin Typewriter & Cash Register Co., Lufkin, Texas for a new Royal typewriter to be located in the County Clerk's office. All voted yes and none no. See Attached. Bid received listed below:

- 1. Lufkin Typewriter & Cash Register Co.-----\$960.00
- Less 10% discount----- (96.00)
- Less trade-in allowance (Royal typewriter)----- (75.00)
- Total amount approved-----789.00

Also, a motion was made by Commissioner Lowe and seconded by Commissioner Mahan to approve the bid received from IBM, Beaumont, Texas, for a new IBM typewriter to be located in the District Clerk's office. All voted yes and none no. See Attached. Bids received are listed below:

- 1. IBM, Beaumont, Texas-----\$828.00
- 2. Lufkin Typewriter & Cash Register Co.----- 960.00
- Less 10% discount----- (96.00)
- Total bid ----- 864.00

A motion was made by Commissioner Riley and seconded by Commissioner Lowe to approve paying bills for the month, as submitted by County Auditor Ann Nichol. All voted yes and none no. See Attached.

A motion was made by Commissioner Mahan and seconded by Commissioner Riley to approve amending the 1984 Budget to increase the amount allotted for Court appointed attorneys for an extra \$12000.00 for the year, as requested by Judge Monte Lawlis, 88th and 1-A Districts. All voted yes and none no. See Attached.

There being no further business, the meeting adjourned.

SIGNED: Allen Sturrock Allen Sturrock, County Judge
Maxie Riley Maxie Riley, Comm. Pct. #1
H. K. Lowe H. K. Lowe, Comm. Pct. #2
Jerry Mahan Jerry Mahan, Comm. Pct. #3
Berton A. Odom Berton A. Odom, Comm. Pct. #4
 ATTEST Grace Bostick Grace Bostick, County Clerk

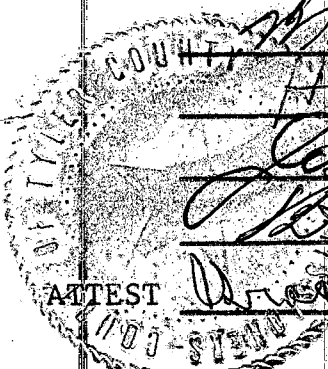

Sequimial committee

VOL 008 PAGE 733

1. Monroe Prescott, 909 Ada St., Woodville, Texas 75979
2. Jackie Blakney, P.O. Box 92, Woodville, Texas 75979
3. Morris Clemmons, 102 S. Charlton, Woodville, Texas 75979
4. Theo Parsons, P.O. Box 216, Woodville, Texas 75979
5. June Maxey, 306 Kelly Blvd., Woodville, Texas 75979
6. Hilda Coats, 101 Nellius St., Apt.# 108, Woodville, Texas 75979
7. Barbara Brown, 407 W. Wheat, Woodville, Texas 75979
8. Jimbo Whitworth, Chester, Texas 75936
9. Vernon Runnels, *First State Bank, Colmesneil, Texas* 75938
10. ~~Dee Dee~~ ^{Dede} Cordes, 36 Lake Drive, Woodville, Texas 75979
11. Fred Sullivan, 211 W. Bluff St., Woodville, Texas 75979
12. Huntly Kenesson, 114 S. Charlton, Woodville, Texas 75979
13. Eleanor Holderman, 1106 Ada, Woodville, Texas 75979
14. Brian Babin, 514 Timberland, Woodville, Texas 75979
15. Grover Die, Rt.1, Box 1290, Woodville, Texas 75979
16. Jéss Collins, St. Rt.1, Box 106 D., Woodville, Texas 75979
17. David Mann, 411 Reid St., Woodville, Texas 75979
18. Percy Lewis, 209 Sweetgum Drive, Woodville, Texas 75979
19. Wyatt Bell, 690 Apple Blossom, Woodville, Texas 75979
20. Alfred Delacruz, 610 Nellius St., Woodville, Texas 75979
21. Jim Clark, 104 N. Reid St., Woodville, Texas 75979
22. Lisa Wood, *1404 W. Dogwood, Woodville, Texas* 75979
23. Lee Mann, 411 Reid St., Woodville, Texas 75979
24. Becky Jinnette, 105 N Pecan St., Woodville, Texas 75979
25. Peggy Burton, 104 Beach St., Woodville, Texas 75979
26. Doretta Gilchrist, P.O. Box 809, Woodville, Texas 75979
27. Sharon Spear, 516 Temple St., Woodville, Texas 75979
28. Quadie Sullivan, *P.O. Box 189* ~~N. Reid St.~~, Woodville, Texas 75979
29. Zadee McKinney, 506 Elm St., Woodville, Texas 75979
30. Ruby Graham, P.O. Box 209, Woodville, Texas 75979
31. Ruth Houston, PO. Box 148, Woodville, Texas 75979
32. Donna Bennett, P.O. Box 125, Ivanhoe, Woodville, Texas 75979
33. Johnny Swafford, P.O. Box 250, Hillister, Texas 77624
34. Henry Shettles, P.O. Box 68, Hillister, Texas 77624
35. Madelon(Graham) McKinney, P.O. Box 209, Woodville, Texas 75979
36. Stephanie Yearwood, 510 Kelly Blvd., Woodville, Texas 75979
37. Robert Barnes Chester, Texas 75936
38. Beulah Schouvillier, P.O. Box 1135, Dogwood Station; Woodville, Texas 75979
39. H.K. Pitts, P.O. Box 531, Warren, Texas 77664
40. James Best, P.O. Box 247, Colmesneil, Texas 75938

41. Helen Gilder, P.O. Box 192, Colmesneil, Texas 75938
42. Iris Whigham, P.O. Box 390, Woodville, Texas 75979
43. James Allen Riley, Rt.1, Box 1008, Woodville, Texas 75979
44. Jack Whitmeyer, Rt.1, Box 110, Colmesneil, Texas 75938
45. Barbara Phillips, P.O. Box 846, Woodville, Texas 75979
46. Jane Mann, 411 Reid St., Woodville, Texas 75979
47. Clyde Gray, P.O. Box 666, Woodville, Texas 75979
48. Dee Gibson, 312 W. Dogwood, Woodville, Texas 75979
49. Phebe Armstrong, P.O. Box 706, Woodville, Texas 75979
50. Clyde Bennett, P.O. Box 125, Ivanhoe, Woodville, Texas 75979
51. E.O. Hill, Rt. 1, Box 962, Woodville, Texas 75979
52. Kitty Peacock, 1188 N. Nellius St., Woodville, Texas 75979
53. Ewell Wood, 1404 W. Dogwood St., Woodville, Texas 75979
54. Ruth Gillespie, 300 S. Reid St., Woodville, Texas 75979
55. Ralph Davis, Rt.1, Box 19, Spurger, Texas 77660
56. Bobby Kiel, P.O. Box 102, Spring Valley, Woodville, Texas 75979
57. ~~Elija Kiel, P.O. Box 102, Spring Valley, Woodville, Texas 75979~~
58. Nelva Elliott, P.O. Box 126, Warren, Texas 77664
59. Allen Sturrock, 100 Courthouse, Woodville, Texas 75979
60. Maxie L. Riley, 100 Courthouse, Woodville, Texas 75979
61. Cathy Sanders (Seneca Road) Woodville, Texas 75979

FND. CON. MON. at M.E. NW/C 6.0325 ACS.
 & ORIG. NE/C Colmesneil School 4 ACS.
 14" Post O X S69°30' E 30.80'
 14" Post O X S16°30' W 4.40'

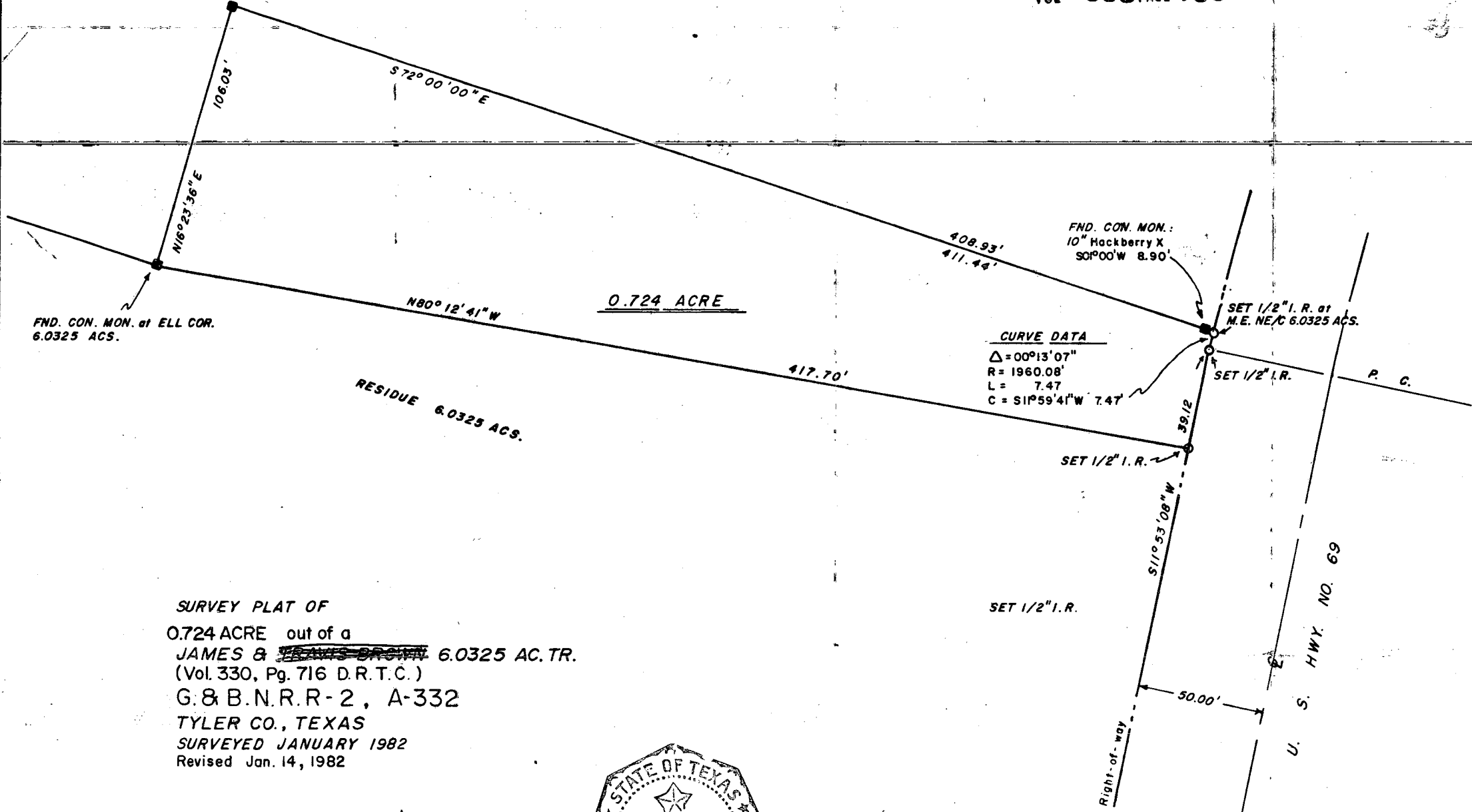

CURVE DATA
 $\Delta = 00^\circ 13' 07''$
 $R = 1960.08'$
 $L = 7.47'$
 $C = S11^\circ 59' 41'' W 7.47'$

SURVEY PLAT OF
 0.724 ACRE out of a
 JAMES & ~~LEWIS BROWN~~ 6.0325 AC. TR.
 (Vol. 330, Pg. 716 D.R.T.C.)
 G. & B.N.R.R-2, A-332
 TYLER CO., TEXAS
 SURVEYED JANUARY 1982
 Revised Jan. 14, 1982

J. Gilbert Johnston
 GILBERT JOHNSTON
 REGISTERED PUBLIC SURVEYOR NO. 2079



N
 SCALE: 1" = 50'

LUFKIN TYPEWRITER & CASH REGISTER CO.

2212 EAST DENMAN AVE.
LUFKIN, TEXAS 75901
TELEPHONES 634-9113 AND 634-9124

VOL 008 PAGE 736

November 8, 1983

Tyler County Clerk
Courthouse
Woodville, Texas 75979

Gentlemen:

Please consider this our bid on the following machine:

Royal 5005 electronic print wheel typewriter with dual pitch.....	\$960.00
Less 10% discount.....	-\$ 96.00
TOTAL BID AMOUNT	<u>\$864.00</u>

We hope to have the pleasure of furnishing you the above
machine soon. Thank you for the opportunity of submitting
this bid.

Sincerely,

Lufkin Typewriter & Cash Register Company

D.C. Satterwhite Lp
D. C. Satterwhite, Sr.
President

Enclosure
DCS:lp

ROYAL

Royal 5005
All-Electronic
Print Wheel Typewriter
with Dual Pitch

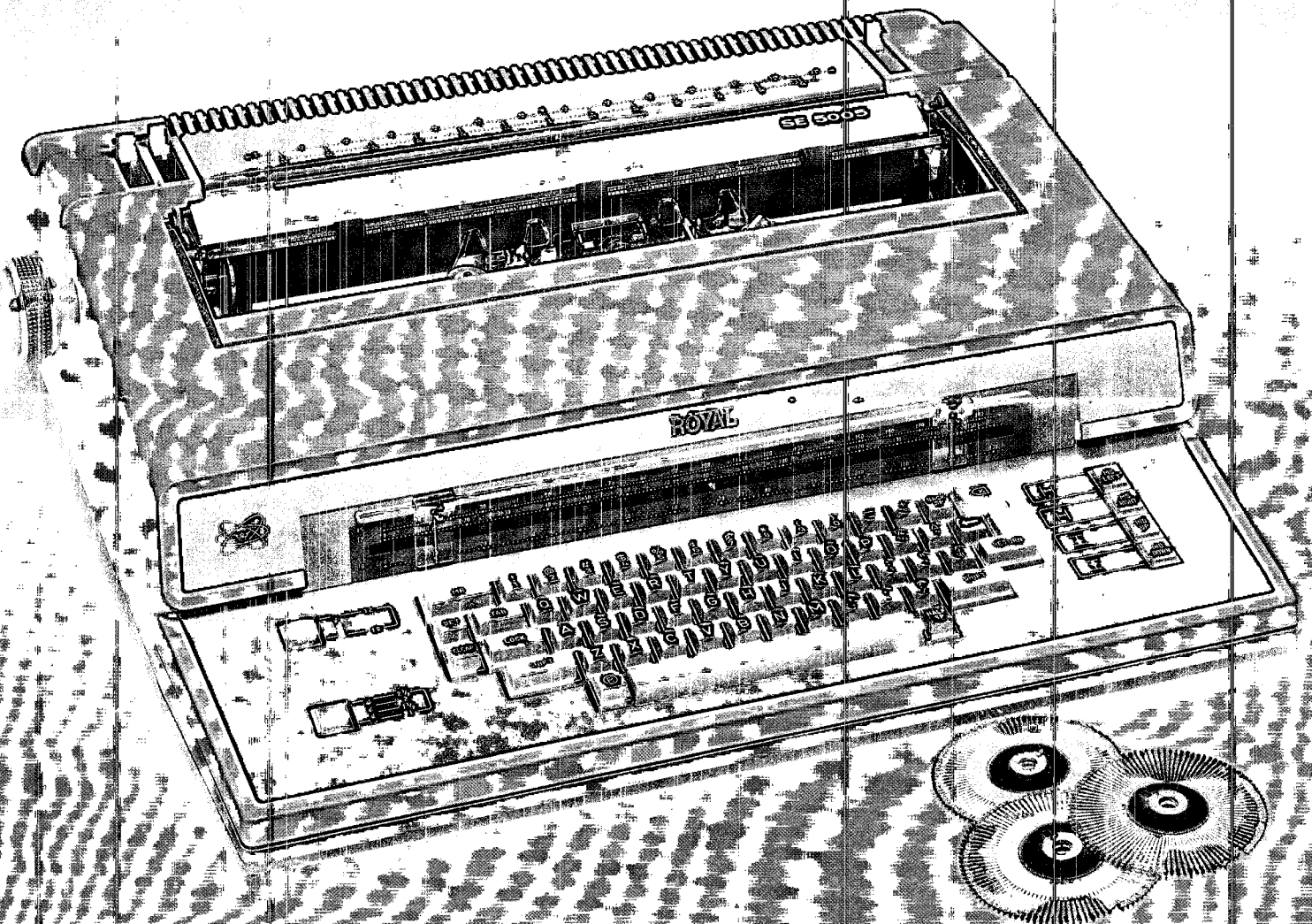

In order to improve efficiency and increase office productivity, the all-electronic Royal 5005 accomplishes automatically much of the tedious work formerly performed manually by the typist. Although it's highly advanced in technology, the Royal 5005 is completely simple to operate. Its electronic keyboard is thoroughly familiar to any typist, so training and adjustment time are minimal. For business, industry and government, the Royal 5005 is the ideal bridge from yesterday's electromechanical typewriters to the automated world of microprocessor controlled electronics.

Control functions right from the keyboard

Virtually all operating functions are simply and easily controlled from the electronic keyboard. At the touch of a key margins are set, paper is positioned up or down, impression control is adjusted and line spacing may be switched to one of four settings. LED indicator lights alert the typist to the function currently in operation: pitch selection, line spacing, half spacing and the shift lock.

The versatile keyboard also provides repeat action for all 46 typing keys, as well as the space bar, the back space and correction keys, plus indexing.

Outpaces high speed typists

The Royal 5005 can handle the fastest typing. Even during sudden bursts of typing speed, the keyboard memory stores the last 16 characters typed and prints them in correct sequence without jamming or character misprinting.

Dual pitch for increased flexibility.

To accommodate the variety of print wheel type styles offered, The Royal 5005 switches pitch instantly from 10 characters per inch to 12 characters per inch. An indicator light reminds the typist which pitch is programmed. It's almost like having two machines in one.

Clean, rapid-changing ribbon cassettes

Royal has completely eliminated the mess and fuss of changing ribbons. Depending on the typing job, the typist may simply drop in a correctable carbon, single-pass carbon, multi-strike carbon or fabric ribbon cassette. Correction tapes are available in Lift-Off for correctable carbon ribbon and Cover Up for the other carbon and fabric ribbons.

Other convenient features

- Retractable paper support/page-end indicator
- Automatic paper insertion
- Automatic paper advance and ejection
- Electronic line space selector for 1, 1½, 2, 2½ spaces
- Up to 500-hour memory retention for functions
- Express back space key
- Vertical half space up and down keys for sub and superscripts
- Horizontal half space key permits insertion of a missing character
- Copy control
- Modular design and self-diagnostic system for rapid servicing

Specifications

Paper capacity: 16½"
 Typing line: 13.2"
 Dimensions: 22.2" (W) x 6.85" (H) x 19.4" (D)
 Weight: 42 lbs.
 Power requirements: 110V AC, 60Hz

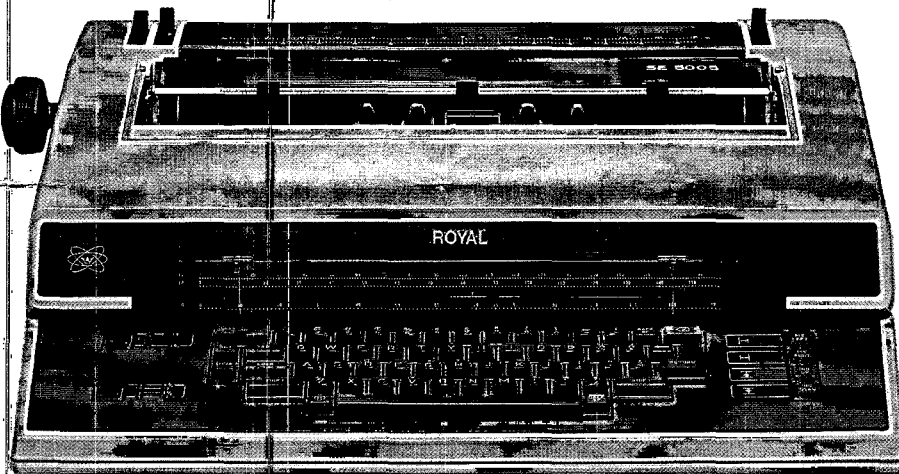

Royal 5005
Simply perfect
because it's
perfectly simple.

Two-line correcting memory automatically lifts off 132 characters

In addition to conventional lift-off corrections, there's an exceptionally large, automatic, 132-character correcting memory. It's simple to delete as much as two complete lines by the use of the correction key. Errors are cleanly removed with a correctable carbon ribbon cassette and lift-off tape.

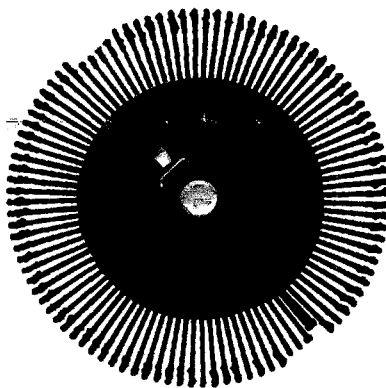

Laser-sharp impressions with interchangeable print wheels

Royal offers a wide selection of print wheels with distinctive type styles to fit any typing job. The durably constructed print wheels produce sharp, clean, perfectly aligned characters. Print wheel technology combined with advanced electronic design produce exceptionally quiet operation.



SUBSIDIARY OF TRIUMPH-ADLER

ROYAL DIVISION
 ARBM, INC.
 1600 Route 22, P.O. Box 1630
 Union, New Jersey 07083

LUFKIN TYPEWRITER & CASH REGISTER CO.
 P. O. BOX 1406 — PH. 634-9113
 LUFKIN, TEXAS 75901

LUFKIN TYPEWRITER & CASH REGISTER CO.

2212 EAST DENMAN AVENUE
P. O. DRAWER 1406
LUFKIN, TEXAS 75901

VOL 008 PAGE 737

NO. _____ TIME: 8:00 AM

NOV 09, 1983

GRACE BOSTICK, COUNTY CLERK
TYLER COUNTY, TEXAS

Tyler County Clerk
Courthouse
Woodville, Texas 75979

BY: *Grace Bostick*

Bid on typerwiter enclosed.

Cs clk

1531509 Royal Trade
#7520 *Sm*



International Business Machines Corporation

P.O. Box 831
Beaumont, Texas 77704
409/899-8300

November 10, 1983

Grace Bostick
County Clerk's Office
100 Courthouse
Woodville, Texas 75979

Dear Ms. Bostick:

In response to a request from the District Clerk's Office, IBM submits the following bid for the purchase of typewriters:

The IBM Correcting Selectric III with standard features,
purchase price....\$828.00 each.

When ordering a quantity of 17 typewriters or more, an additional 7½% discount is applicable.

Thank you for your consideration.

Sincerely,

John Hasson
Marketing Representative

JH/js

IBM

P.O. Box 831
Beaumont, TX 77704

VOL **008** PAGE **739**

Grace Bostick
County Clerk's Office
100 Courthouse
Woodville, Texas 75979

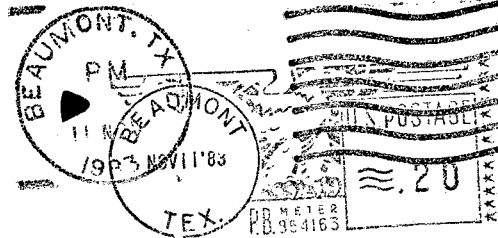

BID ENCLOSED

District Clerk

NO. _____ TIME: 11:00 AM

NOV 11 1983
GRACE BOSTICK, COUNTY CLERK
TYLER COUNTY, TEXAS
BY: *Grace Bostick*

IBM

**The IBM
Electronic
Typewriters**

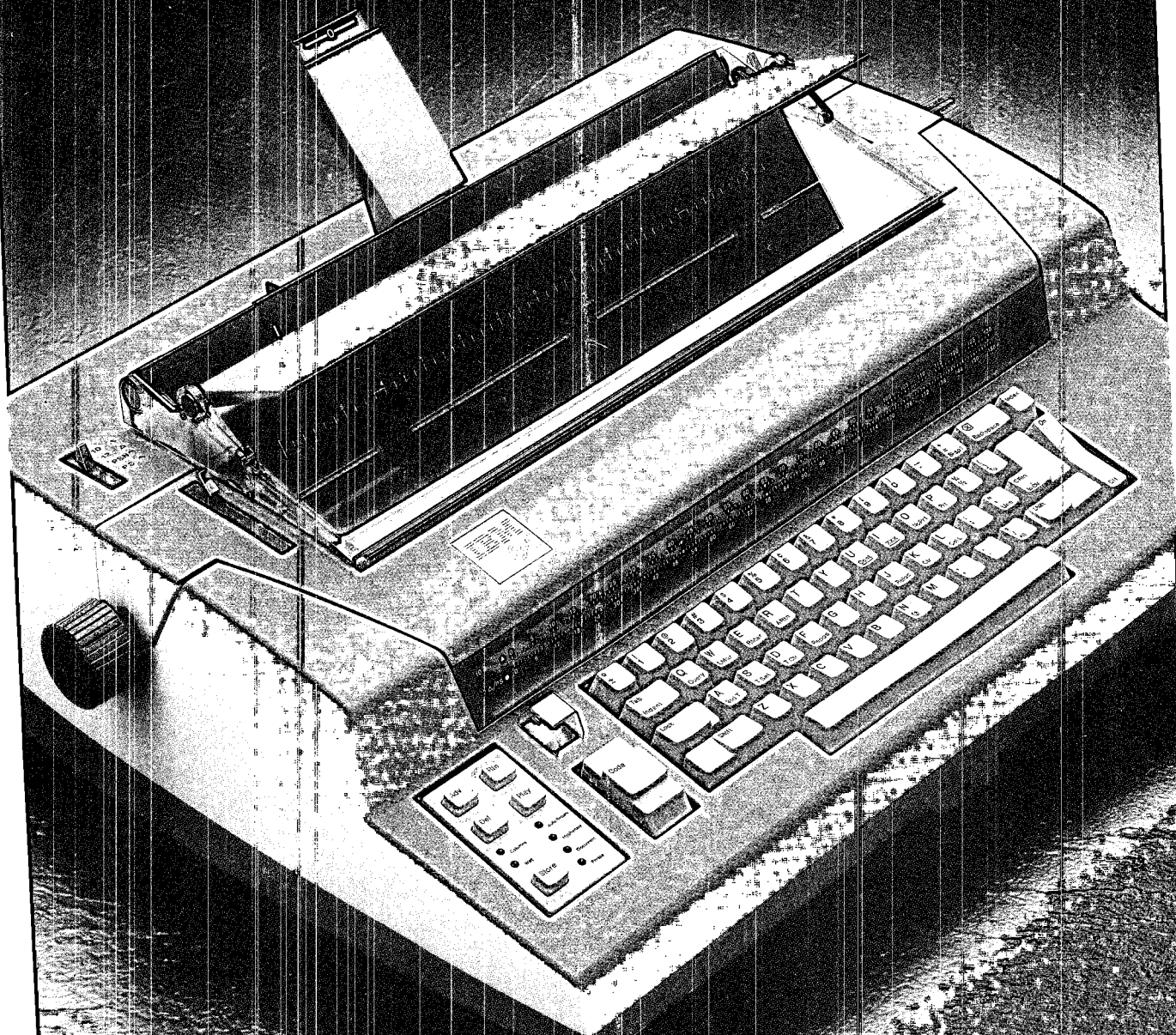

IBM Electronic Typewriter 85 IBM Electronic Typewriter 65

The power of today's technology in IBM Electronic Typewriters moves typing to a high level of ease and efficiency. The Electronic 85 provides time-saving enhancements that help typists achieve increased productivity. Among them, a 15,500 character storage capacity and an electronic document revision capability.

The Electronic 65 has many of the same features as the Electronic 85, but it has a storage capacity of approximately 7,400 characters, and line-by-line document revision. However, it can be *upgraded* in your office to have the same capabilities as the Electronic 85.

Electronic Document / Phrase Storage

Things that are typed repeatedly such as addresses, titles, key phrases, sentences—even entire documents—can be stored and played out error-free, without retyping. Complete documents can be created at your command by combining a series of stored phrases with original typing.

Electronic Format Storage

Formats can be stored, minimizing typewriter set-up and expediting forms fill-in.

Electronic Document Revision

You can delete or type only those portions of the document that need to be revised. Then press the Play key and the typewriter plays out the corrected document, error-free.

IBM Electronic Typewriter Features	Model 85	Model 65
Approximate character storage capacity	15,500	7,400
Document storage	Yes	Yes
Phrase storage	Yes	Yes
Memory control panel	Yes	Yes
Full-line error correction	Yes	Yes
Electronic document revision	Yes	Partial*
Format storage (tabs, margins)	4	4
Automatic carrier return	Yes	Yes
Maximum characters in stroke storage	31	31
Automatic underscoring (word or line)	Yes	Yes
Automatic number alignment	Yes	Yes
Automatic column layout	Yes	Yes
Automatic centering	Yes	Yes
Automatic indenting	Yes	Yes
Automatic justification	Yes	Yes
Triple pitch (10 or 12 characters per inch or proportional spacing)	Yes	Yes
Semi-automatic paper insertion	Yes	No
Lighted carrier position indicator	Yes	No
Type styles (2 standard—others optional)	44**	44**
Case colors (1 standard—others optional)	5	5
Upgradeable	No	Yes

*Line-by-line during playback

**Subject to change

IBM Correcting Selectric® III Typewriter



Letter-Perfect Typing Every Time

The IBM "Selectric" III can help make your typed documents quick, clean and ready for signature the first time. No more lost time retyping an entire page because of a few errors.

With the correcting feature built into the keyboard, correcting errors can be as simple as backspacing with the correcting key, retyping the incorrect character and typing in the correct character. No need to resort to manual correction methods.

IBM Correcting "Selectric" III Features:

- Dual pitch
- Wide range of type styles
- Lighted margin scale
- Page end indicator / paper rest
- Ribbon cassette system
- Acoustical sound hood
- Choice of one standard or seven optional case colors

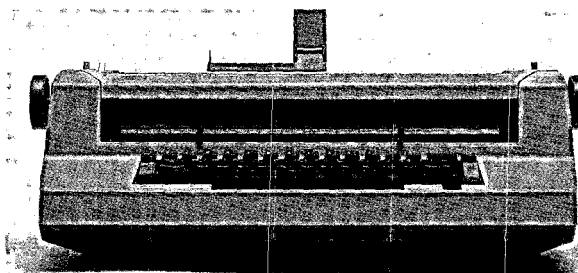

To order, call *IBM Direct* toll free
1 800 631-5582. In Alaska and
Hawaii call 1 800 526-2484.

References in this publication to
IBM products or services do not
imply that IBM intends to make
them available outside the
United States.

Photographs show engineering
design models. Changes may be
incorporated on production
models.

International Business Machines
Corporation
Department 787
4111 Northside Parkway
Post Office Box 2150
Atlanta, Georgia 30055

© Copyright International Business
Machines Corporation, 1982
Printed in USA 202/301
G540-3066-2 U/M 25

LUFKIN TYPEWRITER & CASH REGISTER CO.

2212 EAST DENMAN AVE.
LUFKIN, TEXAS 75901
TELEPHONES 634-9113 AND 634-9124

VOL 008 PAGE 740

November 10, 1983

Tyler County Clerk
100 Courthouse
Woodville, Texas 75979

Re: Bid on typewriter for District Clerk

Gentlemen:

Please consider this our bid on the following machine:

Royal 5005 electronic print wheel typewriter with dual pitch.....	\$960.00
Less 10% discount.....	-\$ 96.00
TOTAL AMOUNT OF BID	<u>\$864.00</u>

We hope to have the pleasure of furnishing you the above machine soon. Thank you for the opportunity of submitting this bid.

Sincerely,

Lufkin Typewriter & Cash Register Company

D.C. Satterwhite
D.C. Satterwhite, Sr.
President

Enclosure
DCS:lp

ROYAL

Royal 5005
All-Electronic
Print-Wheel Typewriter
with Dual Pitch

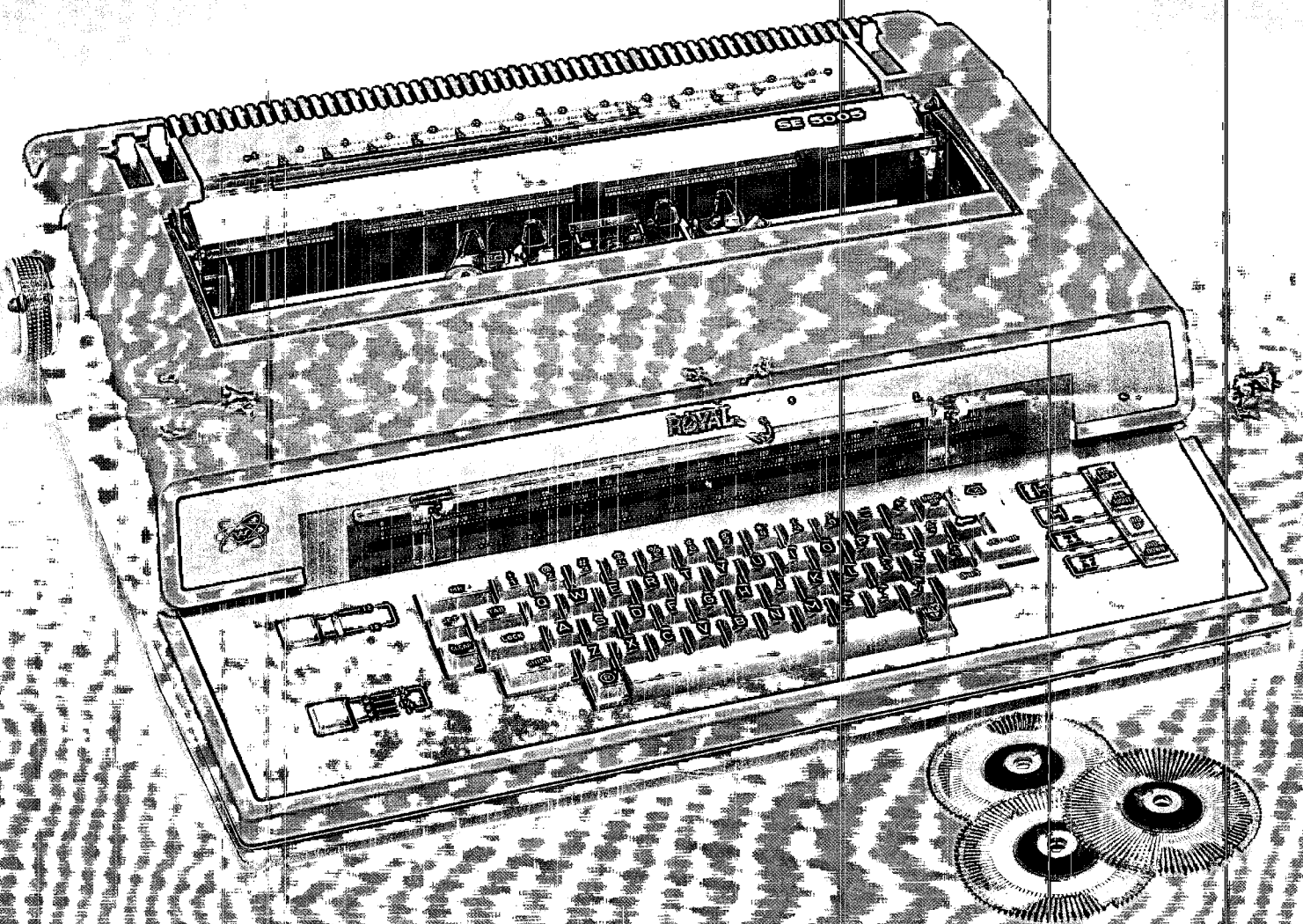

In order to improve efficiency and increase office productivity, the all-electronic Royal 5005 accomplishes automatically much of the tedious work formerly performed manually by the typist. Although it's highly advanced in technology, the Royal 5005 is completely simple to operate. Its electronic keyboard is thoroughly familiar to any typist, so training and adjustment time are minimal. For business, industry and government, the Royal 5005 is the ideal bridge from yesterday's electromechanical typewriters to the automated world of microprocessor controlled electronics.

Control functions right from the keyboard

Virtually all operating functions are simply and easily controlled from the electronic keyboard. At the touch of a key margins are set, paper is positioned up or down, impression control is adjusted and line spacing may be switched to one of four settings. LED indicator lights alert the typist to the function currently in operation: pitch selection, line spacing, half spacing and the shift lock.

The versatile keyboard also provides repeat action for all 46 typing keys, as well as the space bar, the back space and correction keys, plus indexing.

Outpaces high speed typists

The Royal 5005 can handle the fastest typing. Even during sudden bursts of typing speed, the keyboard memory stores the last 16 characters typed and prints them in correct sequence without jamming or character misprinting.

Dual pitch for increased flexibility.

To accommodate the variety of print wheel type styles offered, The Royal 5005 switches pitch instantly from 10 characters per inch to 12 characters per inch. An indicator light reminds the typist which pitch is programmed. It's almost like having two machines in one.

Clean, rapid-changing ribbon cassettes

Royal has completely eliminated the mess and fuss of changing ribbons. Depending on the typing job, the typist may simply drop in a correctable carbon, single-pass carbon, multi-strike carbon or fabric ribbon cassette. Correction tapes are available in Lift-Off for correctable carbon ribbon and Cover Up for the other carbon and fabric ribbons.

Other convenient features

- Retractable paper support/page-end indicator
- Automatic paper insertion
- Automatic paper advance and ejection
- Electronic line space selector for 1, 1½, 2, 2½ spaces
- Up to 500-hour memory retention for functions
- Express back space key
- Vertical half space up and down keys for sub and superscripts
- Horizontal half space key permits insertion of a missing character
- Copy control
- Modular design and self-diagnostic system for rapid servicing

Specifications

Paper capacity: 16½"

Typing line: 13.2"

Dimensions: 22.2" (W) x 6.85" (H) x 19.4" (D)

Weight: 42 lbs.

Power requirements: 110V AC, 60Hz

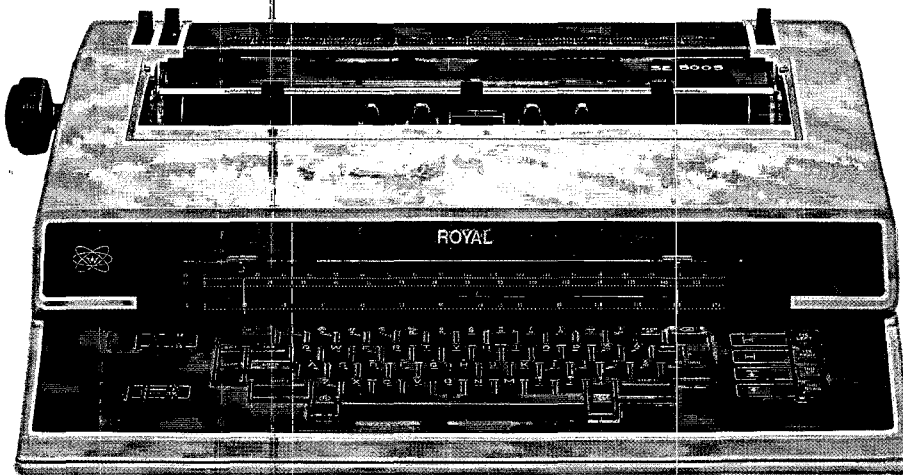

Royal 5005
Simply perfect
because it's
perfectly simple.

Two-line correcting memory automatically lifts off 132 characters

In addition to conventional lift-off corrections, there's an exceptionally large, automatic, 132-character correcting memory. It's simple to delete as much as two complete lines by the use of the correction key. Errors are cleanly removed with a correctable carbon ribbon cassette and lift-off tape.

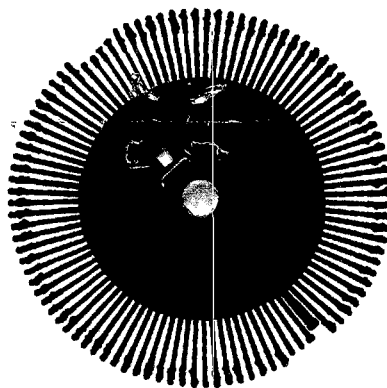

Laser-sharp impressions with interchangeable print wheels

Royal offers a wide selection of print wheels with distinctive type styles to fit any typing job. The durably constructed print wheels produce sharp, clean, perfectly aligned characters. Print wheel technology combined with advanced electronic design produce exceptionally quiet operation.



SUBSIDIARY OF TRIUMPH-ADLER

ROYAL DIVISION
ARBM, INC.
1600 Route 22, P.O. Box 1630
Union, New Jersey 07083

LUTON TYPEWRITER & CASH REGISTER CO.

P.O. BOX 1485

PH. 034-9113

LUTON, TEXAS 75901

LUFKIN TYPEWRITER & CASH REGISTER CO.

2212 EAST DENMAN AVENUE
P. O. DRAWER 1406
LUFKIN, TEXAS 75901

VOL 008 PAGE 741

Tyler County Clerk
100 Courthouse
Woodville, Texas 75979

NO. _____ TIME: 11:00 AM

Bid enclosed for t/w for District Clerk

NOV 14 1983
GRACE BOSTICK, COUNTY CLERK
TYLER COUNTY, TEXAS
BY *Grace Bostick*

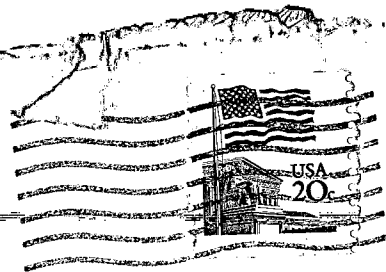

COMMISSIONER'S COURT OF November 18, 1978

Page 1 of 1

CLAIM REGISTER AND MINUTES OF ACCOUNTS ALLOWED, See Below FUND TYLER COUNTY, TEXAS

Claim Number	NAME OF CLAIMANT	NATURE OF CLAIM	Amount of Claim	Da Allo
	<u>ADULT PROBATION</u>			
23772	Rogers Office Supply	Office Supplies	\$ 8.65	
23771	Southwestern Bell	Telephone (long dist calls)	16.92	
			25.57	- T
	<u>JUVENILE PROBATION</u>			
23771	Southwestern Bell	Telephone (long dist. calls)	30.44	/
23781	Deep East Tex. Workers Comp.	Audit Adjustment for 1982-1983	14.84	/
23818	Deep East Tex. Workers Comp.	Dec. Premium	7.60	
			52.88	
	<u>DIST. ATTY. CK. PROCESS.</u>			
23725	Rogers Office Supply	Office Supplies	48.85	
			48.85	- T
	<u>LAW LIBRARY</u>			
23769	Southwestern Bell	Telephone	22.91	
			22.91	- T
	<u>FEDERAL REVENUE SHARING</u>			
1718-a	The Woodsman	Proposed Use Hearing	18.76	
1717-a	Deep East Tex. Workers Comp.	Audit Adjustment 1982-1983- ^{Sold} Waste	17.91	
1719-a	Deep East Tex. Workers Comp.	Dec. Permum-Solid Waste	112.93	
			149.60	- T

APPROVED THIS 18th day of November, 1978

COUNTY JUDGE

Allen Cravens

CLAIMS CHECKED AND APPROVED

COUNTY AUDITOR

Allen Cravens

COMMISSIONER'S COURT OF November 18, 1983 Page 1 of 1

CLAIM REGISTER AND MINUTES OF ACCOUNTS ALLOWED, Road & Bridge III FUND TYLER COUNTY, TEXAS

Claim Number	NAME OF CLAIMANT	NATURE OF CLAIM	Amount of Claim	Da Allo
23702	Allison Chev. Inc.	Parts	\$ 59.45	
23701	Woodville Auto Parts	Parts & Labor	68.39	
23700	Jerrys' Exxon Stateion	Saw Repair	63.71	
23706	A-Z Discount Auto Parts	Parts	32.91	
23705	Martin's Hardware	Bolts	6.12	
23709	Mill Master	Starter Repair	20.00	
23708	Durham Saw Co.	Saw Repair	24.65	
23713	Birdwell's Welding	Welding on Equip.	65.00	
23712	Jimmys Auto Parts	Parts	126.74	
23715	Airco Welding Supply	Welding Supplies	9.35	
23716	Barrett Mack Sales & Service	Filters	138.70	
23720	C & M Repair Service	Labor on Equip.	68.00	
23719	Ewell Equip. Co. Inc.	Parts	39.16	
23718	Jerry's Auto Sales	Repairs to 78 Dump Truck	37.90	
23714	Goodyear Auto Service Center	Tires & Tubes	437.70	
23703	J.E. Gardner Oil Co.	Fuel	3,129.77	
23704	Freeman's	Culverts	849.20	
23710	E & L Lumber Co., Inc.	Lumber	145.04	
23717	Thornton Hardware	Nails	34.00	
23711	Gulf States Utilities Co.	Utilities @ Co. Barn	53.13	
23707	Colmesneil Telephone Co.	Telephone @ Co. Barn	63.31	
23781	Deep East Tex Workers Comp.	Audit Adjustment for 1982-1984	751.75	
23818	Deep East Tex. Workers Comp.	Dec. Premium	385.10	

6609.08

APPROVED THIS 18th day of November, 1983

COUNTY JUDGE

CLAIMS CHECKED AND APPROVED

COUNTY AUDITOR

COMMISSIONER'S COURT OF November 18, 1978

Page 1 of 1

CLAIM REGISTER AND MINUTES OF ACCOUNTS ALLOWED, Road & Bridge II FUND TYLER COUNTY, TEXAS

Claim Number	NAME OF CLAIMANT	NATURE OF CLAIM	Amount of Claim	Da Allo
23692	Gulf Welding Supply Co.	Welding Supplies	\$ 61.63	
23696	Woodville Auto Parts	Parts & Labor	218.76	
23695	H & O Exxon	Battery & Oil Filters	53.50	
23695	H & O Exxon	Tire Repair	12.00	
23699	Goodyear Auto Service Center	Tires	972.42	
23698	Thornton Hardware	Chain, Nails & Misc. Hardware	112.96	
23697	Texaco Inc.	Fuel	14.32	
23694	J.E. Gardner Oil Co.	Fuel	1,228.90	
23693	Chester Water Supply Crop.	Utilities-Co. Barn	9.00	
23781	Deep East Tex. Workers Comp.	Audit Adjustment for 1982-1983	479.78	
23790	Sullivans	Mail Box	6.88	
23818	Deep East Tex. Workers Comp.	Dec. Premium	245.77	
			3415.92	

APPROVED THIS 18th day of November, 1978
[Signature]
 COUNTY JUDGE

CLAIMS CHECKED AND APPROVED
[Signature]
 COUNTY AUDITOR

COMMISSIONER'S COURT OF November 18, 197^x 83Page 1 of 1CLAIM REGISTER AND MINUTES OF ACCOUNTS ALLOWED, Road & Bridge I FUND TYLER COUNTY, TEXAS

Claim Number	NAME OF CLAIMANT	NATURE OF CLAIM	Amount of Claim	D. Alloc
23667	Turners Radiator	Repair to Radiator	\$ 25.00	
23669	Woodville Auto Parts	Parts & Labor	692.56	
23670	A-Z Discount Auto Parts	Parts	73.23	
23671	George P. Bane Inc.	Parts	84.41	
23675	Jo-Be Equipment	Parts	8.75	
23674	Tyler County Tractor	Parts	25.75	
23673	Durham Electric Co.	Repair Starter & Altentor	23.00	
23757	J.E. Gardner Oil	Anti-Freeze	35.40	
23762	Hebert Glass & Mirror	Repair to Equip.	220.60	
23672	Greenwood Exxon	Tire Repair	15.00	
23671	Freeman's	Culverts	296.13	
23668	Mathews Construction Co. Inc.	Asphalt	1,000.00	
23666	Jackson Petroleum-Gulf	Fuel	1,143.97	
23760	Davis Food Market	Gas	16.05	
23759	Jerry's Exxon Station	Supplies	6.90	
23761	South Magnolia Drive Inn Gro.	Ice	43.90	
23782	Seneca Water Supply Corp.	Utilities @ Co. Barn	8.50	
23781	Deep East Texas Workers Comp.	Audit Adjustment for 1982-1983	615.55	
23791	Holderman's Building Center	Shovel	10.31	
23818	Deep East Tex. Workers Comp.	Dec. Premium	315.32	
			4 660.33	

APPROVED THIS 18th day of November, 197^x 83

 COUNTY JUDGE

CLAIMS CHECKED AND APPROVED

 COUNTY AUDITOR

COMMISSIONER'S COURT OF November 18, 1978

Page 7 of 7

CLAIM REGISTER AND MINUTES OF ACCOUNTS ALLOWED, General FUND TYLER COUNTY, TEXAS

Claim Number	NAME OF CLAIMANT	NATURE OF CLAIM	Amount of Claim	D All
INT. 23813	Brookshire Bors.	Janitors Supplies	\$ 213.92	
23733	Consolidated Marketing, Inc.	Bathroom Supplies	129.31	
23810	Sullivans Hardware	Janitors Supplies	19.11	
23734	Shepherds Linen Supply	Janitors Uniforms	30.09	
23735	City of Woodville	Utilities-Courthouse	152.61	
23732	Natkin Service Co.	Repairs to Elevator	235.00	
23800	Phillips Heating & Air Cond.	Repairs to Co. Clerk a/c	78.00	
			968.04	
23800	Phillips Heating & Air Cond.	Repairs to Lighting	34.00	
23768	Southwestern Bell	Telephone	14.83	
			48.83	
23731	University of Tex. Medical Branch	re A. Wilson-Room Rent	25.00	
23804	Jarrots Pharmacy	re G. Langham-Drugs	18.30	
			43.30	
23737	Mrs. Duvall Mixon	re Mary & Tommy Lorenz	465.00	
			465.00	
23768	Southwestern Bell	Telephone	20.65	
			20.65	
		TOTAL GENERAL FUND	35,868.95	

APPROVED THIS 18th day of November, 1978

COUNTY JUDGE

CLAIMS CHECKED AND APPROVED

COUNTY AUDITOR

COMMISSIONER'S COURT OF November 18, 1978

Page 6 of 7

CLAIM REGISTER AND MINUTES OF ACCOUNTS ALLOWED, General FUND TYLER COUNTY, TEXAS

&
DEPT.

RAN
ICE

NSION

NG

Claim Number	NAME OF CLAIMANT	NATURE OF CLAIM	Amount of Claim
23781	Deep East Tex. Workers Comp.	Audit Adjustment for 1982-1983	\$ 1,395.69
23818	Deep East Tex. Workers Comp.	Dec. Premium	714.96
23723	Stafford-Lowdon Co.	Blotts-election Expense	133.15
23729	Monroe Systems	Service Contracts	154.00
23799	Texas Association of Counties	1984 Membership Dues	955.00
23771	Southwestern Bell	Probation Telephone-Service Chg.	61.53
23764	Tyler Co. Tax Appraisal Dist.	Fourth Quarter Payment	11,571.54
			14,905.81
23768	Southwestern Bell	Telephone	26.26
23773	Rogers Office Supply	Office Supplies	17.75
			44.01
23768	Southwestern Bell	Telephone	106.60
23773	Rogers Office Supply	Office Supplies	13.21
			119.81
23768	Southwestern Bell	Telephone	46.30
23809	City of Woodville	Utilities	111.31
23807	Iris Whigham	Mileage to Lufkin re Meeting	27.00
23806	Wal-Mart	Plug for Typewriter	2.18
23763	Lufkin Typewriter	Office Supplies	7.00
23738	Hensarling Auto Service	Adjustment on Battery-Mini-Bus	41.00
23808	Knapp Ford Sales	Repair Glass in Mini-Bus	107.40
23805	Trans to R&B I	Mini-Bus Gas	184.30

APPROVED THIS 18th day of November, 1978

[Signature]
COUNTY JUDGE

To + - 526.49
CLAIMS CHECKED AND APPROVED
[Signature]
COUNTY AUDITOR

COMMISSIONER'S COURT OF November 18, 1978 83Page 5 of 7CLAIM REGISTER AND MINUTES OF ACCOUNTS ALLOWED, General FUND TYLER COUNTY, TEXAS

Claim Number	NAME OF CLAIMANT	NATURE OF CLAIM	Amount of Claim	D All
23773	Rogers Office Supply	Supplies	\$ 5.90	
23814	Impact Printing	Receipts books	40.00	
23798	Pitney Bowes	Meter Rental on Pastage Machine	104.25 227.95	
23768	Southwestern Bell	Telephone	88.85	
23773	Rogers Office Supply	Office Supplies	122.05	
23728	Hartgraphics	Printed Forms	515.92	
23729	Monroe Systems	Calculator Ribbons	39.45	
23730	Western Data Services, Inc.	Lease & Voters Registration	595.00 1361.27	
23768	Southwestern Bell	Telephone	168.53	
23728	Hartgraphics	Printed Forms	20.69	
23773	Rogers Office Supply	Office Supplies	30.30	
23723	Stafford-Lowdon Co.	Office Suppleis	21.84	
23722	Walraven	Printed Forms	61.65	
23811	3-M	Micro Film Consultant Reader	328.72	
23811	3-M	Supplies Micro Film	666.63	
23721	Xerox Corp.	Copy Machine	222.87	
23722	Lufkin Typewriter	Calculator M#2608 Ser#38041178	184.50 1705.73	

APPROVED THIS 18th day of November, 1978 83

 COUNTY JUDGE

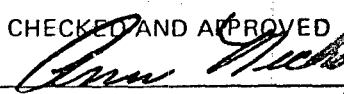
CLAIMS CHECKED AND APPROVED

 COUNTY AUDITOR

COMMISSIONER'S COURT OF November 18, , 1983

Page 4 of 7

CLAIM REGISTER AND MINUTES OF ACCOUNTS ALLOWED, General FUND TYLER COUNTY, TEXAS

Claim Number	NAME OF CLAIMANT	NATURE OF CLAIM	Amount of Claim	Da Allo
<u>III</u> 23765	Walraven	Docket Books	\$ 376.87	
23787	Colmesneil Telephone Co.	Telephone	14.47	
			391.34	
<u>IV</u> 23768	Southwestern Bell	Telephone	37.51	
			37.51	
<u>ATTY.</u> 23768	Southwestern Bell	Telephone	43.07	
23728	Hartgraphics Inc.	Printed Forms	104.32	
23773	Rogers Office Supply	Office Supplies	44.10	
23793	West Publishing Co.	Inserts to Law Books	11.50	
23726	Becker Printing Co.	Printed Forms	149.66	
23727	County of Jasper	Certified Copies	3.00	
			355.62	
<u>ATTY.</u> 23768	Southwestern Bell	Telephone	152.11	
			152.11	
<u>JUR</u> 23795	Kinney & Owens Atty-at-Law	Legal Fee-T.Cain VS Tyler County	197.50	
			197.50	
<u>JUDGE</u> 23768	Southwestern Bell	Telephone	175.00	
			175.00	
<u>JUR</u> 23768	Southwestern Bell	Telephone	45.12	
23792	Office Supply Center	Office Supplies	9.97	
			55.09	
<u>JURER</u> 23768	Southwestern Bell	Telephone	77.80	

Cont'd

APPROVED THIS 18th day of November , 1983

Allen Enlow
COUNTY JUDGE

CLAIMS CHECKED AND APPROVED
Allen Enlow
COUNTY AUDITOR

COMMISSIONER'S COURT OF November 18, 1983

Page 3 of 7

CLAIM REGISTER AND MINUTES OF ACCOUNTS ALLOWED, General FUND TYLER COUNTY, TEXAS

Claim Number	NAME OF CLAIMANT	NATURE OF CLAIM	Amount of Claim	D All
JUD. COURT 23778	James M. Allison, Atty.	Court Appt'd re W.P. Watson, Jr.	\$ 530.00	
23780	Robert H. Mann, Atty.	Court Appt'd re		
		O. Mckinney, Jr.	350.00	
		B. G. McFarland	250.00	
		B. Elkins	200.00	
		M. D. White	350.00	
		B.H. Adams	250.00	
		J. Wagnor	271.50	
		C.E. Justice	275.00	
		M. Sowell	321.50	
		K.R. Ellis	350.00	
			2,618.00	
			3,639.66	
JUD. COURT 23779	Jerome P. Owens, Atty.	Court Appt'd re K.P. Prince	250.00	
23778	James M. Allison, Atty.	Court Appt'd re J.E. Mobley	250.00	
			500.00	
I 23768	Southwestern Bell	Telephone	101.61	
23773	Rogers Office Supply	Office Supplies	15.69	
23763	Lufkin Typewriter	Office Supplies	32.00	
23765	Walraven	Docket Books	451.06	
			600.36	
II 23768	Southwestern Bell	Telephone	20.65	
23765	Walraven	Docket Books	227.92	

248.57

APPROVED THIS 18th day of November, 1983

Allen [Signature]
COUNTY JUDGE

CLAIMS CHECKED AND APPROVED
[Signature]
COUNTY AUDITOR

COMMISSIONER'S COURT OF November 18, 1978

Page 2 of 7

CLAIM REGISTER AND MINUTES OF ACCOUNTS ALLOWED, General FUND TYLER COUNTY, TEXAS

Claim Number	NAME OF CLAIMANT	NATURE OF CLAIM	Amount of Claim	
Cont'd 23804	Jarrotts Pharmacy	RX for Prisoners	\$ 18.40	
23745	Tyler County Hospital	Medical Treatment for Prisoner	80.35	
23796	South Magnolia Drive Inn Gro.	Food for Prisoners	16.93	
23752	SunBeam Thrift Store	Bread for Prisoners	24.50	
23748	Wal-Mart	Supplies for Prisoners	13.16	
23813	Brookshire Brothers	Food for Prisoners (3 Months)	1,314.83	
		Tot.	6,182.99	
S. 23792	Office Supply Center	Office Supplies-Hi-Way Patrol	38.36	
23763	Lufkin Typewriter	Office Supplies	21.00	
23768	Southwestern Bell	Telephone	112.94	
23801	Motorola, Inc.	Two Portable Radios-D.P.S.	1,964.00	
		Tot.	2,136.30	
CLERK 23724	Xerox Corp.	Copy Machine	315.00	
23768	Southwestern Bell	Telephone	54.31	
23723	Stafford-Lowdon Co.	Grand Jury Minutes	420.61	
		Tot.	789.92	
23768	Southwestern Bell	Telephone	51.66	
23740	Edna LaBove	Court Reporter-Contract Labor	240.00	
23779	Jerome P. Owens, Atty.	Court Appt'd re J.C. Lewis	200.00	

Cont'd

APPROVED THIS 18th day of November, 1978

Allen [Signature]
COUNTY JUDGE

CLAIMS CHECKED AND APPROVED

[Signature]
COUNTY AUDITOR

COMMISSIONER'S COURT OF November 18, 1983

Page 1 of 7

CLAIM REGISTER AND MINUTES OF ACCOUNTS ALLOWED, General FUND TYLER COUNTY, TEXAS

Claim Number	NAME OF CLAIMANT	NATURE OF CLAIM	Amount of Claim	
23751	Exxon Co.	Gas	\$ 150.02	
23750	Gulf Oil Corp.	Gas	81.92	
23756	Mobil Oil Credit Corp.	Gas	22.19	
23755	Texaco Inc.	Gas	53.07	
23741	J.E. Gardner Oil Co.	Gas	1,725.46	
23744	Diamond Shamrock	Gas	27.74	
23768	Southwestern Bell	Telephone	341.02	
23768	Southwestern Bell	Telephone-Fire Dept.	36.22	
23746	Tyco Feed	Weight Tickets	4.00	
23773	Rogers Office Supply	Office Supplies	47.45	
23804	Jarrots Pharmacy	Office Supplies	2.85	
23794	Clemmons Ins. Agency	Blanket Bond on Deputies	164.84	
23739	John Q. Gilchrist, M.D.	Physical on J. Barefield-(Jailer)	15.00	
23753	Irvin Sabrsula, M.D.	Physical on M. McCulley-(Jailer)	28.00	
23747	Bobs' Prescription Shop	Photos	28.84	
23748	Wal-Mart	Film	124.48	
23803	The Troque Shop	Repairs to Vehicles	625.00	
23743	Woodville Auto Parts	Repairs to Vehicles	120.30	
23742	Allison Chevrolet	Repairs to Vehicles	56.17	
23802	Racal-Milgo	Teletype	147.00	
23749	Big Thicket Communications	Radio Maint.	203.25	
23754	Deep East Tex. Council of Govts.	12 Chanel Mobil Radio-50/50 Grant	710.00	

Cont'd

APPROVED THIS 18th day of November, 1983

Allen [Signature]
COUNTY JUDGE

CLAIMS CHECKED AND APPROVED

[Signature]
COUNTY AUDITOR

INTER-OFFICE MEMO

1-A Jud. Relief

Date 11-17-83

RE: BUDGET OVER-RUN

There is a budget overage in the following line items:

<u>Court Reporter Travel</u>	\$ <u><329.50></u>
<u>Court Appnt. Attys</u>	<u><1303.08></u>
<u>Salary D. Judge</u>	<u><76.00></u>

Please come by the office within the next five days and amend your budget.

Thanks,

Ann
Ann Nichol
County Auditor

DO NOT WRITE BELOW - AUDITORS USE ONLY

Amendment:

Line Item:	From	To	Increase/ (Decrease)
<u>Court Rept. Vac. Rel.</u>	<u>500.00</u>	<u>- 0 -</u>	<u>(500.00)</u>
<u>Salary D. Judge</u>	<u>2832.00</u>	<u>3332.00</u>	<u>500.00</u>
<u>Court Bailiff</u>	<u>800.00</u>	<u>624.00</u>	<u>(176.00)</u>
<u>Sal. D. Appnt</u>	<u>3332.00</u>	<u>3508.00</u>	<u>176.00</u>
<u>Court Bailiff</u>	<u>624.00</u>	<u>500.00</u>	<u>(124.00)</u>
<u>From to 88 Court Bailiff</u>	<u>300.00</u>	<u>424.00</u>	<u>124.00</u>
<u>Court Appnt. Attorneys</u>	<u>3500.00</u>	<u>15500.00</u>	<u>12000.00</u>
<u>ECY Cash Balance</u>	<u>Decrease by 12,000.00</u>		<u>(12,000.00)</u>

11-22-83
Date of Signature

Patricia Dean
Authorization Signature

* This will take care of 88th + 1-A & Court Appointed Attorneys.

500th Vac Relief

FILED FOR RECORD: 1-30-1980 at 3:00 O'clock PM
DULY RECORDED: 1-31-1980 at 4:00 O'clock AM
INSTRUMENT NO. 80-437 GRACE BOSTICK, TYLER CO. CLK.
Seta Birdwell BY: Seta Birdwell Deputy

WARRANTY DEED
(LONG FORM)

VOL **430** PAGE **660**

THE STATE OF TEXAS
COUNTY OF TYLER

} KNOW ALL MEN BY THESE PRESENTS:

That WE, JAMES H. BROWN and wife, JACKIE BROWN

of the County of TYLER and State of TEXAS for and in
consideration of the sum of TEN (\$10.00) -----
----- DOLLARS

and other valuable consideration to the undersigned paid by the grantee herein named, the receipt of which
is hereby acknowledged,

have GRANTED, SOLD AND CONVEYED, and by these presents do GRANT, SELL AND CONVEY unto
TYLER COUNTY COMMISSIONERS' COURT, PRECINCT #3
100 Courthouse, Woodville, Texas 75979

of the County of TYLER and State of TEXAS, all of
the following described real property in TYLER County, Texas, to-wit:

BEING 0.724 acres of land out of a 6.0325 acre tract of land out
of the G & BN RR Section # 2, ABSTRACT NO. 332, in Tyler County,
Texas, as described in deed dated March 6, 1975, from Charles
E. Faircloth to James H. Brown and Travis Brown, and recorded
in Volume 330, Page 716, of the Deed Records of Tyler County,
Texas, and being more fully described in Exhibit "A" which is
attached hereto and made a part hereof for all intents and
purposes.

TO HAVE AND TO HOLD the above described premises, together with all and singular the rights and appurtenances thereto in anywise belonging, unto the said grantee s , their heirs and assigns forever; and we do hereby bind ourselves, our heirs, executors and administrators to WARRANT AND FOREVER DEFEND all and singular the said premises unto the said grantee s , heirs and assigns, against every person whomsoever lawfully claiming or to claim the same or any part thereof.

This conveyance is made and accepted subject to the following matters: to the extent same are in effect at this time; any and all restrictions, covenants, conditions, easements, rights-of-way and leases, if any, relating to the hereinabove described property, but only to the extent they are still in effect, shown of record in the hereinabove mentioned County and State.

This conveyance is further made and accepted subject to the reservation of oil, gas and other minerals, and/or royalties heretofore made by prior grantors.

EXECUTED this 3rd day of January, A. D. 19 84

James H. Brown

JAMES H. BROWN

Jackie Brown

JACKIE BROWN

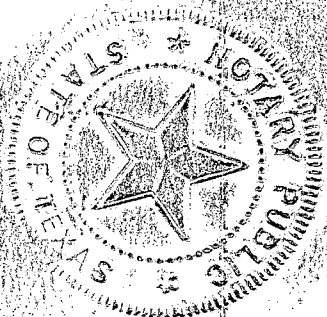

Mailing address of each grantee:

Name: Tyler County Commissioners' Court
Address: 100 Courthouse
Woodville, Texas 75979

Name:
Address:

(Acknowledgment)

STATE OF TEXAS
COUNTY OF TYLER }

This instrument was acknowledged before me on the 3rd day of January, 19 84, by JAMES H. BROWN and wife, JACKIE BROWN

My commission expires:

11/14/87

Cora Behring

Notary Public, State of Texas

Notary's printed name: Cora Behring

JOHNSTON SURVEYING CO.

J. Gilbert Johnston, R. P. S.

P. O. Box 391

Silsbee, Tx. 77656

Phone: 713/385-7972

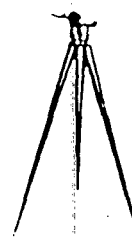

VOL 430 PAGE 662

STATE OF TEXAS
COUNTY OF TYLER

Field notes describing 0.724 acre of land out of a 6.0325 acre tract out of the G. & B. N. R. R. Section 2, Abstract 332, Tyler County, Texas. Said 6.0325 acre tract is more fully described in a deed dated March 6, 1975, from Charles E. Faircloth to James H. & Travis Brown and recorded in Volume 330, Page 716, et seq., of the Deed Records of Tyler County, Texas.

BEGINNING at a concrete monument found at the most easterly northwest corner of said 6.0325 acre tract and the original northeast corner of the old Colmesneil school 4 acre tract. From which said concrete monument a 14" Post Oak bears S 69 deg. 30 min. E 30.80 feet and a 14" Post Oak bears S 16 deg. 30 min. W 4.40 feet.

THENCE S 72 deg. 00 min. 00 sec. E along and with a north line of said 6.0325 acre tract at 408.93 feet pass a concrete monument found and at 411.44 feet a 1/2" iron rod set for the most easterly northeast corner of said 6.0325 acre tract in the west right-of-way line of U. S. Highway No. 69, fifty feet perpendicular distance from its centerline. From which said concrete monument a 10" Hackberry bears S 01 deg. 00 min. W 8.90 feet.

THENCE in a southwesterly direction along and with a curve to the left in said right-of-way line, fifty feet perpendicular distance from and concentric with its centerline 7.47 feet to a 1/2" iron rod set at the P. C. of said curve. Said curve has a central angle of 00 deg. 13 min. 07 sec. and the chord of which bears S 11 deg. 59 min. 41 sec. W 7.47 feet.

THENCE S 11 deg. 53 min. 08 sec. W continuing along and with the west right-of-way line of said highway, fifty feet perpendicular distance from and parallel with its centerline 39.12 feet to a 1/2" iron rod set for corner.

THENCE N 80 deg. 12 min. 41 sec. W 417.70 feet to a concrete monument found at an ell corner of said 6.0325 acre tract in the east line of said school tract.

THENCE N 16 deg. 23 min. 36 sec. E along and with a west line of said 6.0325 acre tract and the east line of said school tract 106.03 feet to the PLACE OF BEGINNING, containing 0.724 acre of land.

surveyed January, 1982.

I, J. Gilbert Johnston, Registered Public Surveyor No. 2079 in the State of Texas, do hereby certify that the above field notes reflect an actual survey made by me on the ground and according to law; that the limits, boundaries, and corners, with the marks natural and artificial, are truly described in the foregoing field notes just as I found them on the ground.

Given under my hand this 14 th Day of January, 1982.

THIS INSTRUMENT WAS RECEIVED FOR
RECORDING IN OUR OFFICE IN THIS CONDITION

J. Gilbert Johnston
Registered Public Surveyor No. 2079

I certify that the discrete number microfilm images between the Title Page and the Certificate of Legality and Authenticity have been made in strict accordance with Article 1941 (a), Vernon's Texas Civil Statutes, and that each image is a true, correct, and exact copy of the page or pages of the Identified instrument of writing, legal document, paper or record which had been filed for record on the date and at the time stamped on each; that no microfilm image or images were substituted for any original microfilm image or images between the Title page and this Certificate, microfilmed this the 31 day of January, 1984, from the Deed Records of the County of Tyler, Texas. Starting image no. Vol. 430 Page 660 Ending image no. Vol. 430 Page 663
 GRACE BOSTICK
Grace Bostick

430-663